

REV	DATE	BY	DESCRIPTION
00	06MAY10	C.Z.S.Y	ES
A1	06MAY10	C.Z.S.Y	REVISED ECR-10-009788

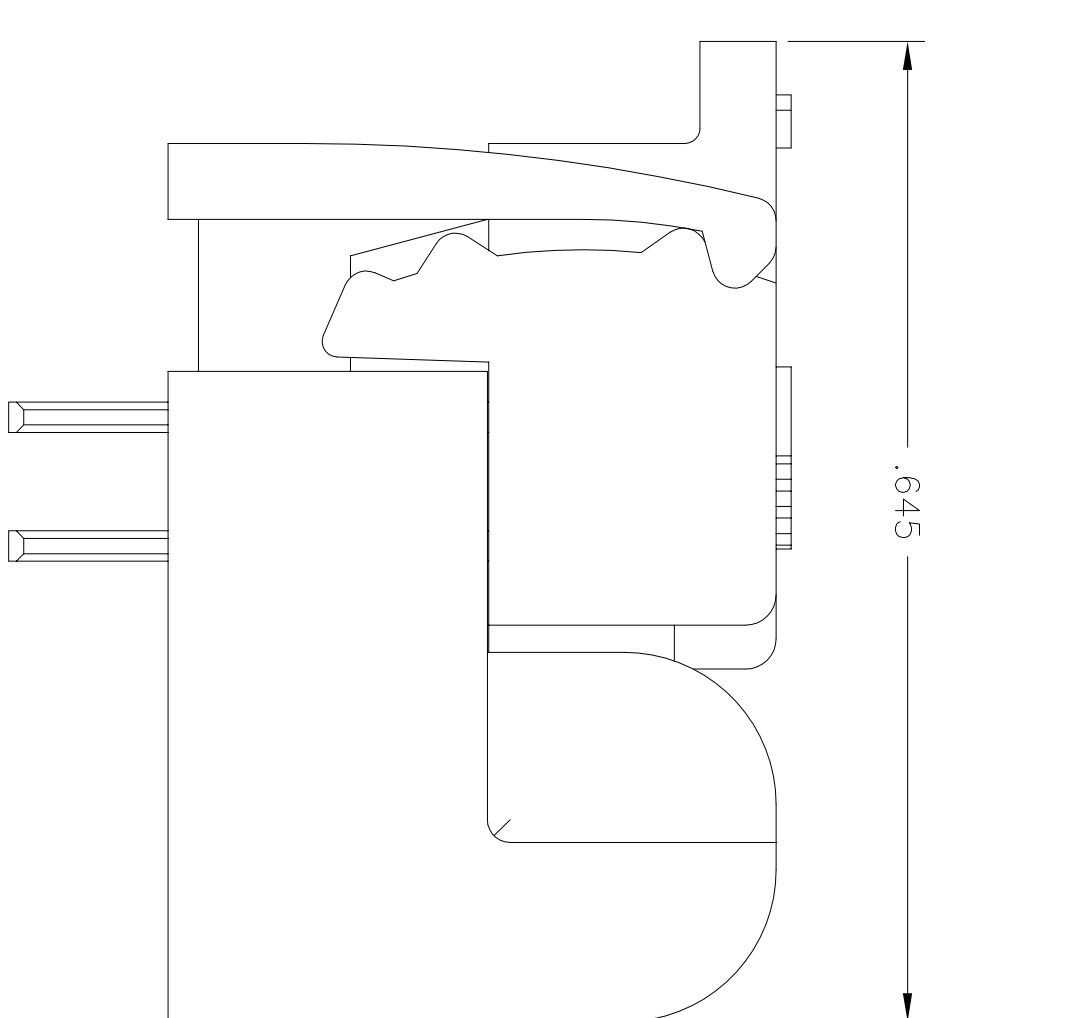

CLOSED POSITION

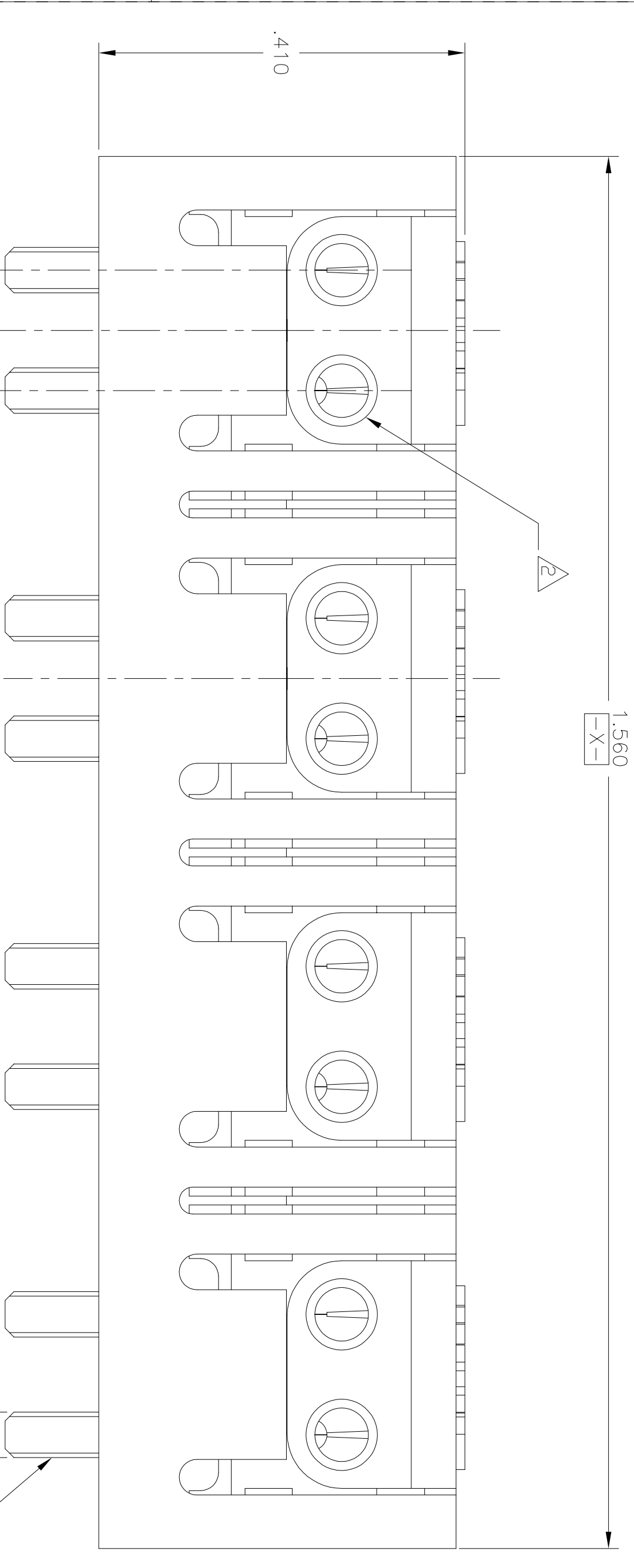
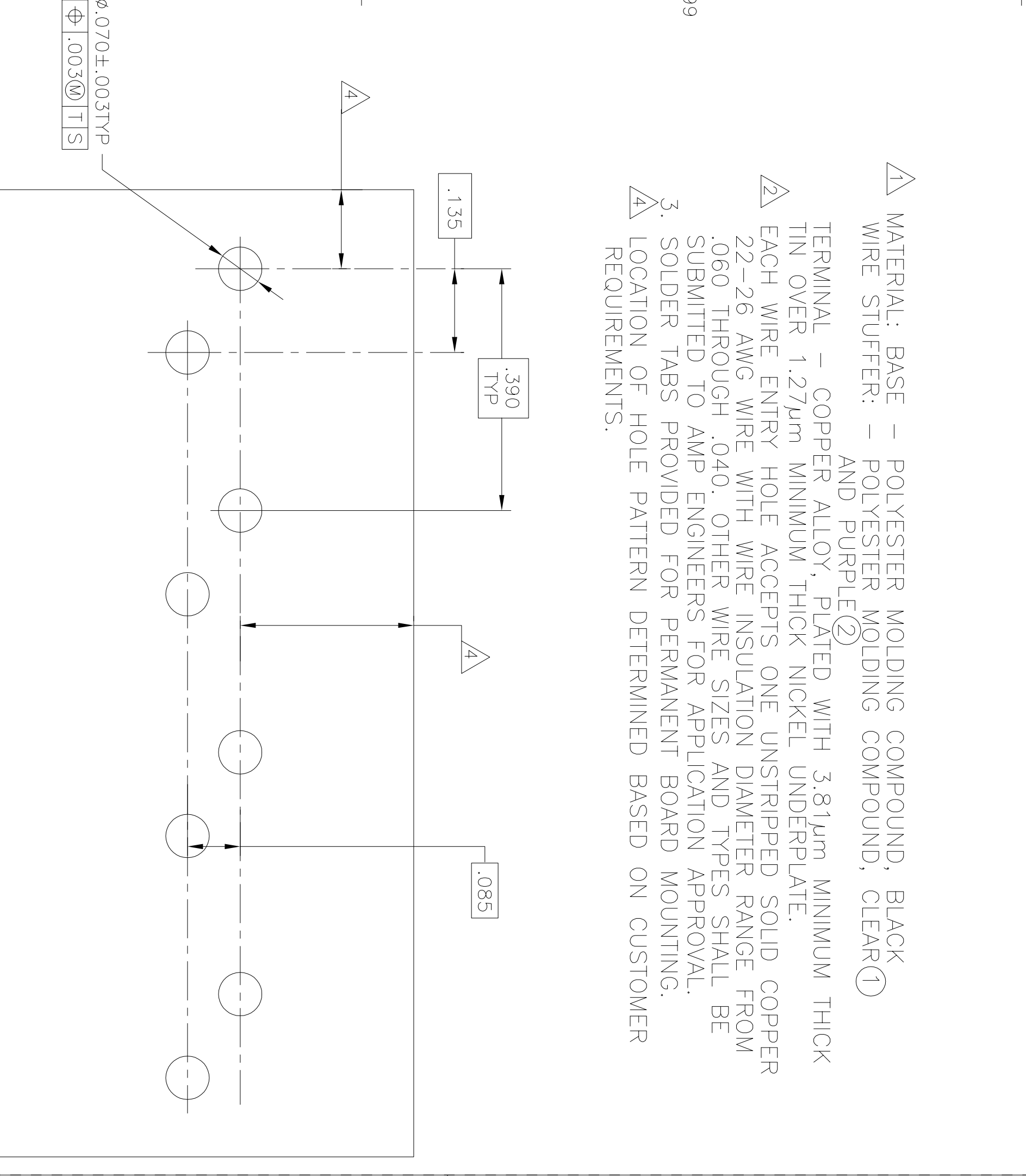
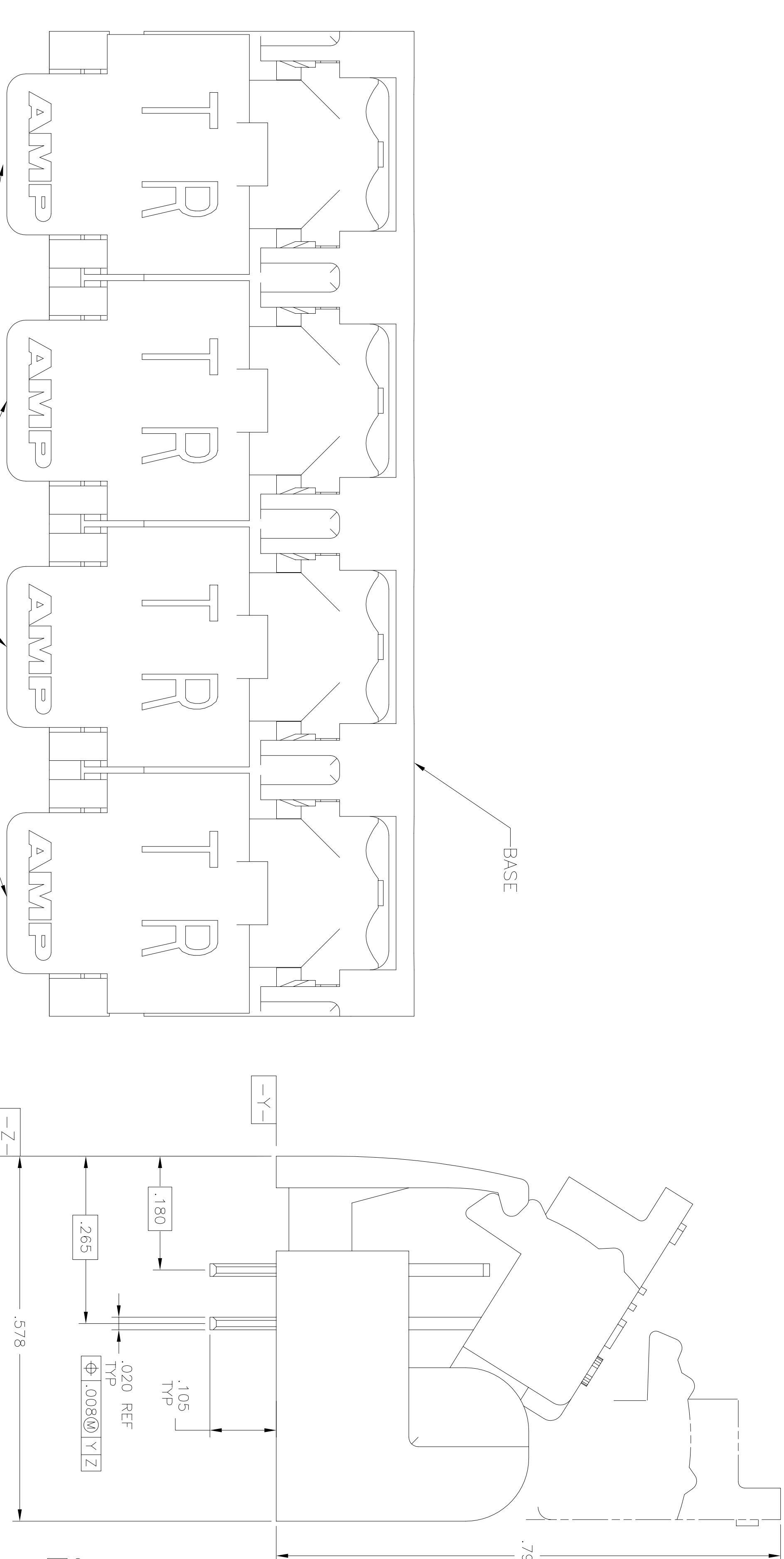
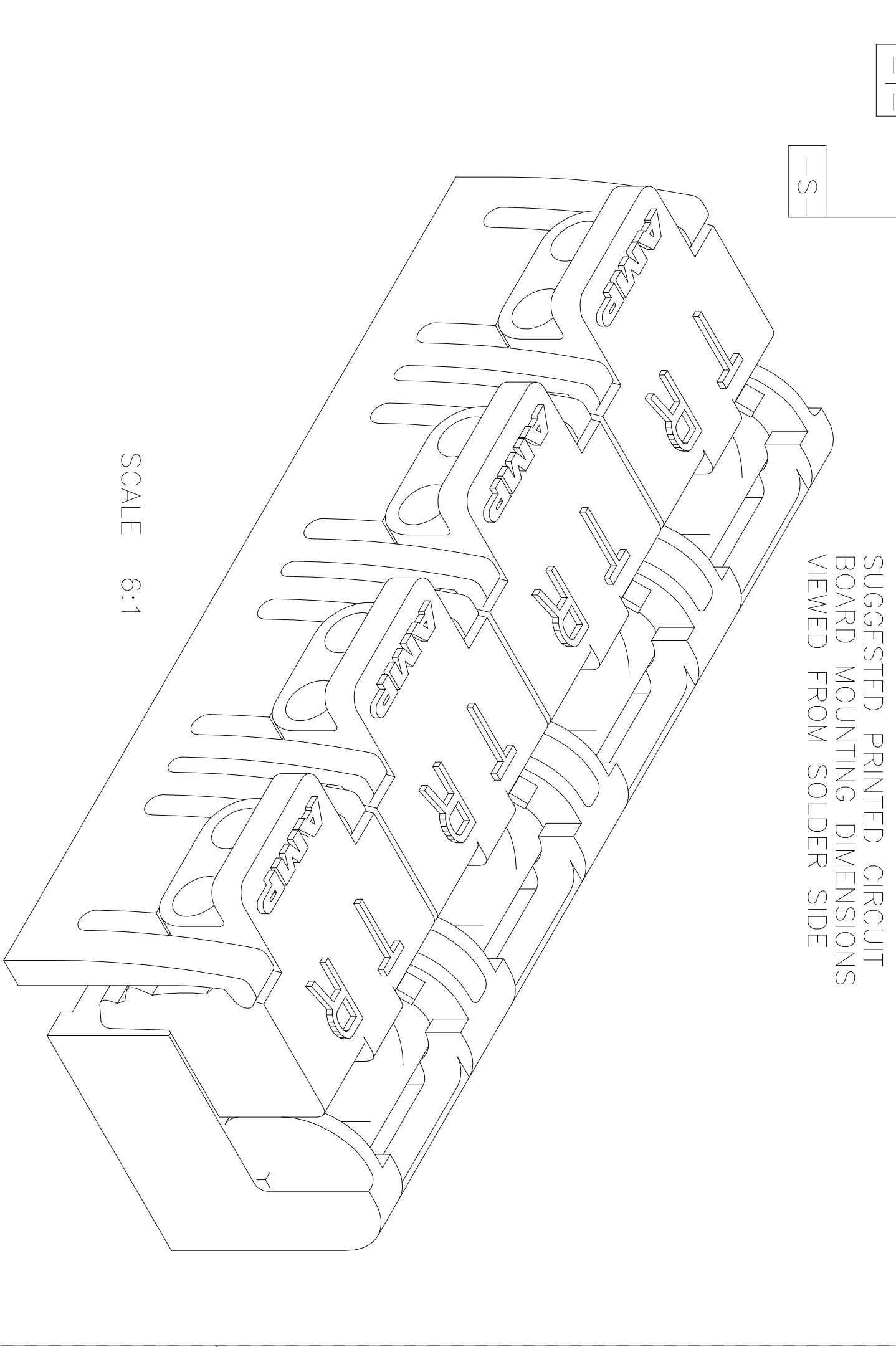

SUGGESTED PRINTED CIRCUIT BOARD MOUNTING DIMENSIONS VIEWED FROM SOLDER SIDE

SCALE 6:1

- △ MATERIAL: BASE - POLYESTER MOLDING COMPOUND, BLACK
- △ WIRE STUFFER: - POLYESTER MOLDING COMPOUND, CLEAR ①
- △ TERMINAL - COPPER ALLOY, PLATED WITH 3.81μm MINIMUM THICK TIN OVER 1.27μm MINIMUM THICK UNDERPLATE.
- △ EACH WIRE ENTRY HOLE ACCEPTS ONE UNSTRIPPED SOLID COPPER 22-26 AWG WIRE WITH WIRE INSULATION DIAMETER RANGE FROM .060 THROUGH .040. OTHER WIRE SIZES AND TYPES SHALL BE SUBMITTED TO AMP ENGINEERS FOR APPLICATION APPROVAL.
- △ SOLDER TABS PROVIDED FOR PERMANENT BOARD MOUNTING.
- △ LOCATION OF HOLE PATTERN DETERMINED BASED ON CUSTOMER REQUIREMENTS.

TERMINAL .051 REF TYP

Φ .008 Y X S

STUFFER COLOR	P/N
② PURPLE △	1932559-1
① CLEAR △	

THIS DRAWING IS A CONTROLLED DOCUMENT. 15JAN2010

DESIGNER	C. ZHU	DATE	15JAN2010
APPROVED	YAO	DATE	15JAN2010
NAME	Tyco Electronics Corporation	ADDRESS	Shanghai, P.R. China, 200233
PROJECT	ASSEMBLY, FOUR PAIR SINGLE ENTRY PIVOT II CONNECTOR	SIZE	A1
APP. NO.	108-1657	DATE CODE	00779
REV. NO.	114-6062	DRAWING NO.	1932559
MATERIAL		SCALE	8:1
FINISH		SHEET	1 of 1
REVISIONS		REV	A1

RESTRICTED TO CUSTOMER DRAWING