

YELLOW LED

PARAMETERS	SYMBOL	MAX.	MIN.	TYP.	UNITS
POWER DISSIPATION	P_D	100	--		mW
AVE FORWARD CURRENT	I_{AF}	30	--		mA
PEAK FORWARD CURRENT	I_{PF}	80	--		mA
FORWARD VOLTAGE	V_F	2.8	1.8	2.1	V
REVERSE VOLTAGE	V_R	5	--		V
REVERSE CURRENT	I_R	100	--		μA
EMISSION WAVELENGTH	λ_P			590	nm
LUMINOUS INTENSITY	I_F		5.0	12.0	mcd

RED LED

PARAMETERS	SYMBOL	MAX.	MIN.	TYP.	UNITS
POWER DISSIPATION	P_D	80	--		mW
AVE FORWARD CURRENT	I_{AF}	30	--		mA
PEAK FORWARD CURRENT	I_{PF}	80	--		mA
FORWARD VOLTAGE	V_F	2.8	1.8	2.2	V
REVERSE VOLTAGE	V_R	5	--		V
REVERSE CURRENT	I_R	100	--		μA
EMISSION WAVELENGTH	λ_P			695	nm
LUMINOUS INTENSITY	I_F		0.7	2.2	mcd

NOTES:

1. ALL DIMENSIONS IN MM [INCH]
2. GENERAL TOLERANCE: X.X=±0.4
X.XX=±0.25
3. TERM. NOS. FOR REFERENCE ONLY
4. RATINGS: 12mA @24V
- ▲ 5. CONTACT FIXED AND MOVING:
COPPER ALLOY W/ GOLD PLATE
6. CONTINUOUS CURRENT RATING: 120mA
7. POWER RATING: 240mW
8. OPERATING FORCE: <200gf
9. OPERATING TRAVEL: 2.5±0.2mm
10. ▲ DENOTES CRITICAL PARAMETER.

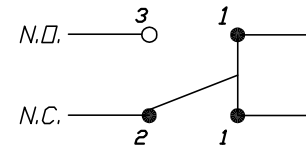
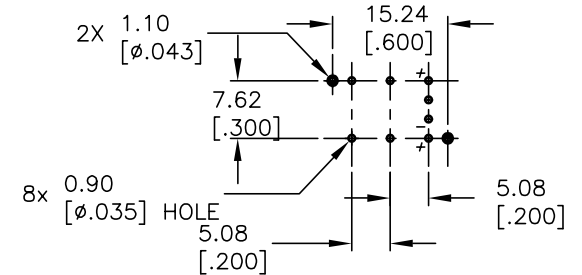

CIRCUIT: SPDT CONTACT CONFIGURATION

E-SWITCH®

TITLE				
5501MWHTYELRED				
SCALE	DATE	DR	DWG	REV
1:1	7/26/04	AR	XR0238P	A

A	14185	RELEASED FOR PRODUCTION	7/26/04	AR
REV.	ECN No.	DESCRIPTION	DATE	CHKD

THE INFORMATION CONTAINED IN THIS DOCUMENT IS PROPRIETARY TO E-SWITCH AND IS NOT TO BE COPIED OR TRANSFERRED