

Surface Mount Fuse with Holder, 12 x 5.2 mm, Time-Lag T, 125 VAC, 125 VDC



UL 248-14 · 125 VAC · 125 VDC · Time-Lag T



Description

- Directly solderable on printed circuit boards
- OMZ 125 = OMT 125 + OMH 125

Standards

- UL 248-14
- CSA C22.2 no. 248.14

References

[Packaging Details](#)

Weblinks

[pdf datasheet](#), [html-datasheet](#), [General Product Information](#), [Packaging details](#), [Approvals](#), [CE declaration of conformity](#), [RoHS](#), [CHINA-RoHS](#), [REACH](#), [Distributor-Stock-Check](#), [Detailed request for product](#)

Technical Data

| | |
|------------------------------|--|
| Rated Voltage | 125 VAC, 125 VDC |
| Rated current | 0.25 - 5 A |
| Breaking Capacity | 100 A |
| Characteristic | Time-Lag T |
| Mounting | PCB,SMT |
| Admissible Ambient Air Temp. | -40°C to 85°C |
| Climatic Category | 40/085/21 acc. to IEC 60068-1 |
| Material: Housing | Thermoplastic, UL 94V-0 |
| Material: Terminals | Tin-Plated Copper |
| Unit Weight | 0.47 g |
| Storage Conditions | 0°C to 60°C, max. 70% r.h. |
| Product Marking |  Type, Rated current, Approvals |

| | |
|------------------------------|---|
| Soldering Methods | Reflow |
| | Soldering Profile |
| Solderability | 245 °C / 3 sec acc. to IEC 60068-2-58, Test Td |
| Resistance to Soldering Heat | 260 °C / 10 sec acc. to IEC 60068-2-58, Test Td |

Detailed information on product approvals, code requirements, usage instructions and detailed test conditions can be looked up in [General Product Information](#)

Dimension

 12 mm

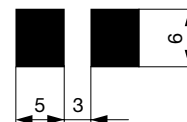
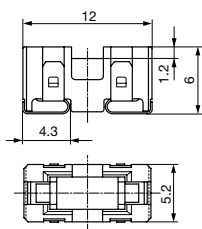

Soldering pads

Pre-Arcing Time

| Rated Current In | 1.0 x In min. | 2.0 x In max. | 8.0 x In min. | 8.0 x In max. |
|------------------|---------------|---------------|---------------|---------------|
| 0.25 A - 0.375 A | 4 h | 60 s | 2 ms | 10 ms |
| 0.5 A - 6.3 A | 4 h | 60 s | 5 ms | 100 ms |

Time-Current-Curves

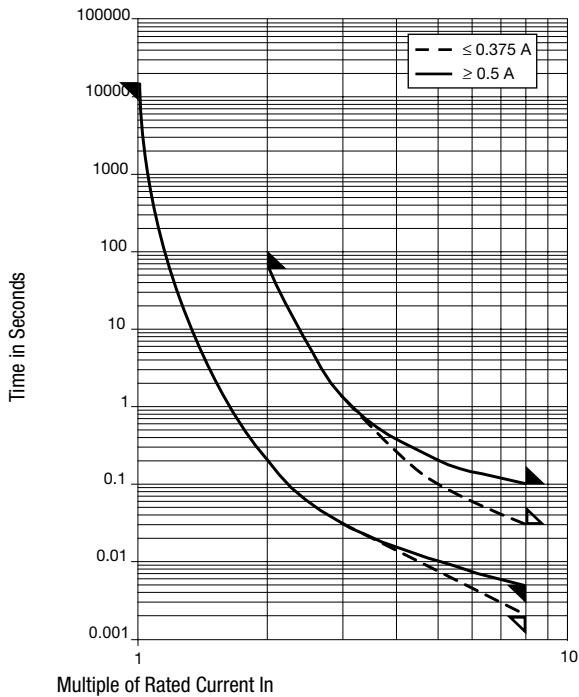

All Variants

| Fuse | Holder | Rated Current [A] | Rated Voltage [VAC] | Rated Voltage [VDC] | Breaking Capacity | Voltage Drop 1.0 I _n typ. [mV] | Power Dissipation 1.0 I _n typ. [mW] | Melting I ² t 8.0 In typ. [A ² s] | Order Number |
|------|--------|-------------------|---------------------|---------------------|-------------------|---|--|---|--------------|
| ● | ● | 0.25 | 125 | 125 | 1) | 142 | 35.5 | 0.02 | 3404.2320.11 |
| ● | ● | 0.25 | 125 | 125 | 1) | 142 | 35.5 | 0.02 | 3404.2320.22 |
| ● | ● | 0.25 | 125 | 125 | 1) | 142 | 35.5 | 0.02 | 3404.2320.23 |
| ● | ● | 0.375 | 125 | 125 | 1) | 123 | 46.1 | 0.054 | 3404.2321.11 |
| ● | ● | 0.375 | 125 | 125 | 1) | 123 | 46.1 | 0.054 | 3404.2321.22 |
| ● | ● | 0.375 | 125 | 125 | 1) | 123 | 46.1 | 0.054 | 3404.2321.23 |
| ● | ● | 0.5 | 125 | 125 | 1) | 95 | 47.5 | 0.16 | 3404.2322.11 |
| ● | ● | 0.5 | 125 | 125 | 1) | 95 | 47.5 | 0.16 | 3404.2322.22 |
| ● | ● | 0.5 | 125 | 125 | 1) | 95 | 47.5 | 0.16 | 3404.2322.23 |
| ● | ● | 0.75 | 125 | 125 | 1) | 92 | 69 | 0.43 | 3404.2323.11 |
| ● | ● | 0.75 | 125 | 125 | 1) | 92 | 69 | 0.43 | 3404.2323.22 |
| ● | ● | 0.75 | 125 | 125 | 1) | 92 | 69 | 0.43 | 3404.2323.23 |
| ● | ● | 1 | 125 | 125 | 1) | 88 | 88 | 0.77 | 3404.2324.11 |
| ● | ● | 1 | 125 | 125 | 1) | 88 | 88 | 0.77 | 3404.2324.22 |
| ● | ● | 1 | 125 | 125 | 1) | 88 | 88 | 0.77 | 3404.2324.23 |
| ● | ● | 1.5 | 125 | 125 | 1) | 82 | 123 | 1.73 | 3404.2325.11 |
| ● | ● | 1.5 | 125 | 125 | 1) | 82 | 123 | 1.73 | 3404.2325.22 |
| ● | ● | 1.5 | 125 | 125 | 1) | 82 | 123 | 1.73 | 3404.2325.23 |
| ● | ● | 2 | 125 | 125 | 1) | 75 | 150 | 3.58 | 3404.2326.11 |
| ● | ● | 2 | 125 | 125 | 1) | 75 | 150 | 3.58 | 3404.2326.22 |
| ● | ● | 2 | 125 | 125 | 1) | 75 | 150 | 3.58 | 3404.2326.23 |
| ● | ● | 2.5 | 125 | 125 | 1) | 137 | 343 | 5.6 | 3404.2327.11 |
| ● | ● | 2.5 | 125 | 125 | 1) | 137 | 343 | 5.6 | 3404.2327.22 |
| ● | ● | 2.5 | 125 | 125 | 1) | 137 | 343 | 5.6 | 3404.2327.23 |
| ● | ● | 3 | 125 | 125 | 1) | 128 | 384 | 8.06 | 3404.2328.11 |
| ● | ● | 3 | 125 | 125 | 1) | 128 | 384 | 8.06 | 3404.2328.22 |
| ● | ● | 3 | 125 | 125 | 1) | 128 | 384 | 8.06 | 3404.2328.23 |
| ● | ● | 3.5 | 125 | 125 | 1) | 119 | 417 | 11.76 | 3404.2329.11 |

| Fuse | Holder | Rated Current [A] | Rated Voltage [VAC] | Rated Voltage [VDC] | Breaking Capacity | Voltage Drop 1.0 In typ. [mV] | Power Dissipation 1.0 I _n typ. [mW] | Melting I ² t 8.0 In typ. [A ² s] | Order Number |
|------|--------|-------------------|---------------------|---------------------|-------------------|-------------------------------|--|---|--------------|
| ● | ● | 3.5 | 125 | 125 | 1) | 119 | 417 | 11.76 | 3404.2329.22 |
| ● | ● | 3.5 | 125 | 125 | 1) | 119 | 417 | 11.76 | 3404.2329.23 |
| ● | ● | 4 | 125 | 125 | 1) | 77 | 308 | 12.3 | 3404.2330.11 |
| ● | ● | 4 | 125 | 125 | 1) | 77 | 308 | 12.3 | 3404.2330.22 |
| ● | ● | 4 | 125 | 125 | 1) | 77 | 308 | 12.3 | 3404.2330.23 |
| ● | ● | 5 | 125 | 125 | 1) | 79 | 395 | 20.8 | 3404.2331.11 |
| ● | ● | 5 | 125 | 125 | 1) | 79 | 395 | 20.8 | 3404.2331.22 |
| ● | ● | 5 | 125 | 125 | 1) | 79 | 395 | 20.8 | 3404.2331.23 |

Availability for all products can be searched real-time:<http://www.schurter.com/en/Stock-Check/Stock-Check-SCHURTER>

1) 100 A @ 125 VAC , p.f. ≥ 0.95 / 100 A @ 125 VDC

Packaging Unit .xx = .11 Plastic Bag (100 pcs.)
 .xx = .22 Blister Tape 33 cm Reel (750 pcs.)
 .xx = .23 Blister Tape 38 cm Reel (1500 pcs.)