

PRODUCT NO.
10017963-XXXXX

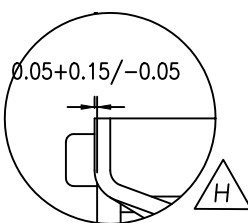

DETAIL B

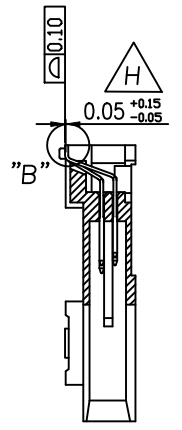
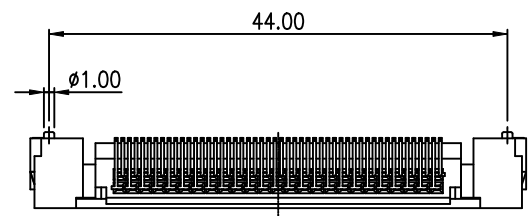

SECTION A-A

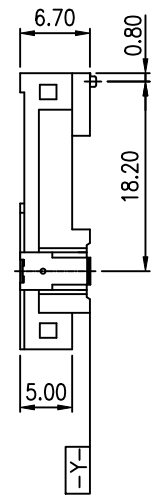
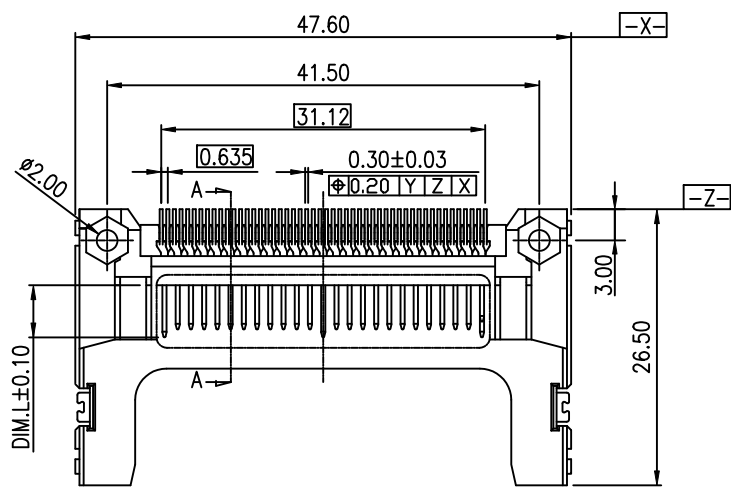

| PIN TYPE | DIM.L±0.10 | PIN NUMBER |
|----------|------------|----------------|
| DETECT | 3.50 | 25,26 |
| CENERAL | 4.25 | ALL OTHER PINS |
| POWER | 5.00 | 1,13,38,50 |

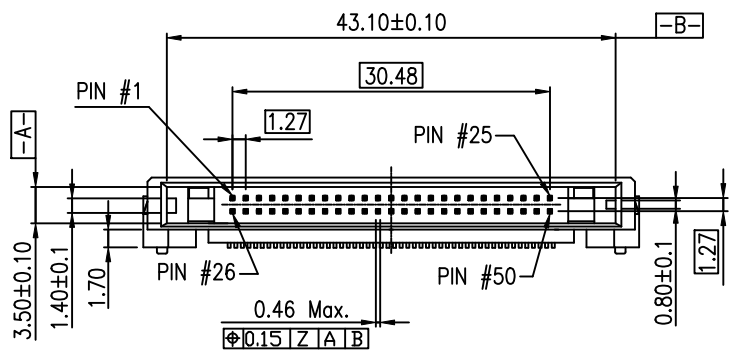

Tous droits strictement reserves. Reproduction ou communication a des tiers interdite sous quelque forme que ce soit sans autorisation ecrite du proprietaire. Propriete de c FCI. Droits de reproduction FCI.



All rights strictly reserved. Reproduction or issue to third parties in any form whatever is not permitted without written authority from the proprietor. Property of FCI. Copyright FCI.

| mat'l. code | | | | tolerances unless otherwise specified | | | CUSTOMER COPY | | FCI | |
|-------------|----------------|-------|----------|---------------------------------------|--------------|-----------|---------------|--|-----------------------|--|
| ltr | ecn no | dr | date | linear | .X ± 0.30 | | projection | | title | |
| C | T03-0415 | J.C | 9/22/03' | | .XX ± 0.20 | | MM | | CF CARD HEADER TYPE 1 | |
| D | T05-0122 | A.C | 6/07/05 | angles | .XXX ± 0.10 | | scale | | product family | |
| E | T07-1119 | WL | 07/24/07 | | 0° ± 2° | | A4 | | size dwg no | |
| F | T08-1014 | WL | 01/24/08 | dr | JASON HSU | 01/09/03' | 10017963 | | code | |
| G | T08-1023 | WL | 02/12/08 | engr | JASON HSU | 01/09/03' | 1 of 3 | | TWN | |
| H | T10-0056 | S.LIN | 10'-5-06 | chr | STERLING LIN | 01/09/03' | | | sheet | |
| | | | | appd | JAMES HSU | 01/09/03' | | | 1 of 3 | |
| sheet index | revision sheet | H 1 | H 2 | H 3 | | | | | | |

Tous droits strictement reserves. Reproduction ou communication a des tiers interdite sous quelque forme que ce soit sans autorisation ecrite du proprietaire. Propriete de c FCI. Droits de reproduction FCI.



All rights strictly reserved. Reproduction or issue to third parties in any form whatever is not permitted without written authority from the proprietor. Property of FCI. Copyright FCI.

1 | 2

3

4

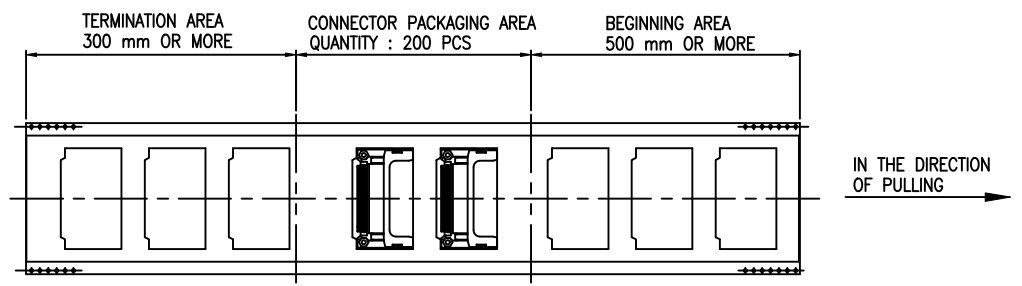
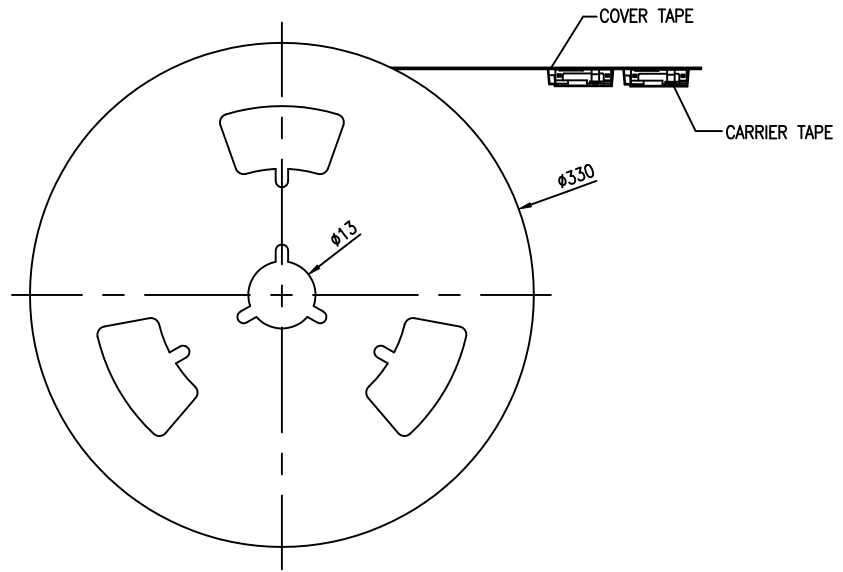
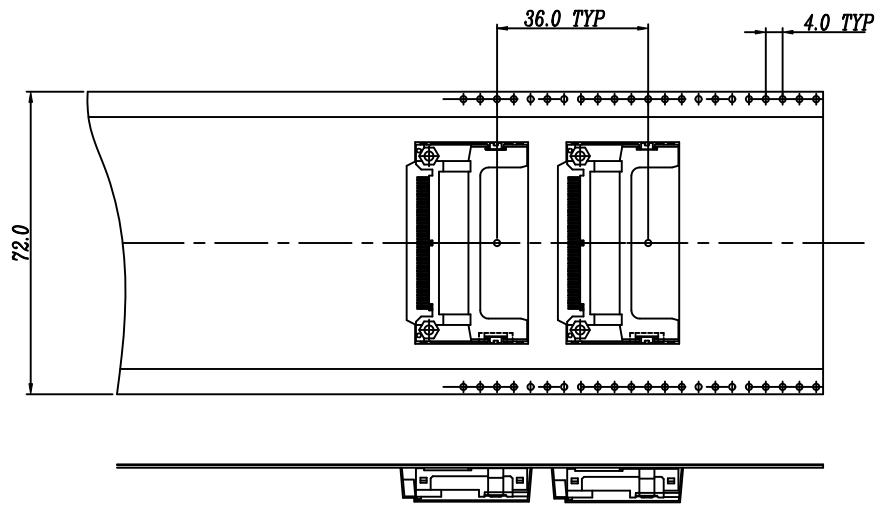
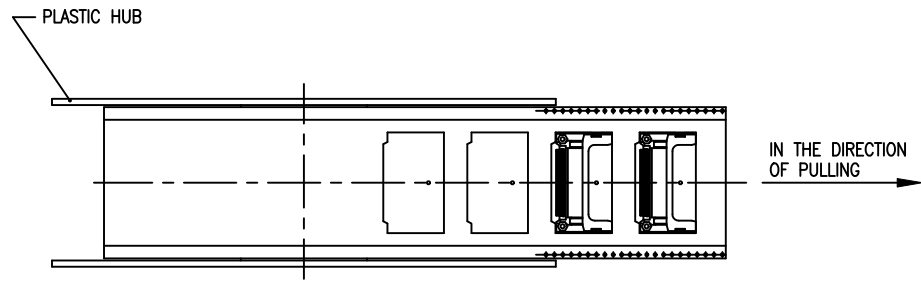

COMPOSITION OF PACKAGING

NOTES:

1. CARRIER TAPE : PS , t=0.35mm.
2. COVER TAPE : PE.
3. PLASTIC HUB : PS.

| | | | | | | | | | | | | | |
|-------------|----------------|----|------|---------------------------------------|--------------|-----------|-------|---------------|-----------------------|-------|------|--------------------|--|
| mat'l. code | | | | tolerances unless otherwise specified | | | | CUSTOMER COPY | | FCI | | www.fciconnect.com | |
| ltr | ecn no | dr | date | linear | .X ± 0.30 | | | projection | title | | | | |
| H | | | | | .XX ± 0.20 | | | | CF CARD HEADER TYPE 1 | | | | |
| | | | | | .XXX ± 0.10 | | | | product family | | | | |
| | | | | angles | 0° ±2' | | | MM | size | | code | | |
| | | | | dr | JASON HSU | 01/09/03' | scale | | A4 | | TWN | | |
| | | | | enrg | JASON HSU | 01/09/03' | | 10017963 | | sheet | | | |
| | | | | chr | STERLING LIN | 01/09/03' | | | 2 of | | | | |
| | | | | appd | JAMES HSU | 01/09/03' | | | | | | | |
| sheet index | revision sheet | | | | | | | | | | | | |

1 | 2

3

4

ACAD

PDM: Rev:H

STATUS: Released

cage code
22526
Printed: May 08, 2010

NOTES:

1. Materials:
 Housing: High Temperature Thermoplastic , UL94V-0, Color/Natural.
 Contact: Copper Alloy.
 Solderable Holddown: Copper Alloy.

2. Specification:
 Product Spec: GS-12-240.
 Packaging Spec: GS-14-1010.

3. Tin/Lead Plating Spec:
 Contact: Under Plated 50u" Min Nickel All Over,
 100u" Min Tin/Lead in Solder Tail Area,
 Selective Gold Plating in Contact Area.
 Solderable Holddown: Under Plated 50u" Min Nickel,
 Plated 100u"Min Tin/Lead All Over.

4. Lead-Free Plating Spec:
 Contact: Under Plated 50u" Min Nickel All Over,
 100u" Min Pure Matte Tin in Solder Tail Area,
 Selective Gold Plating in Contact Area.
 Solderable Holddown: Under Plated 50u" Min Nickel,
 Plated 100u"Min Pure Matte Tin All Over.

5. The Housing Will Withstand Exposure to 260°C Peak
 Temperature For 10 Seconds In A Convection, IR Or Vaper
 Phase Reflow Oven.

6. This Product (10017963-XXXXLX) Meets the European Union
 Directive as Described in GS-22-008, Sub Clause 3.1.
 (2002/95/EC).

7. PART NUMBER DESCRIPTION:
 10017963-X050XX

LEAD-FREE PLATING OPTION
 BLANK: TIN/LEAD PLATING(SEE NOTE3).
 LF: LEAD-FREE PLATING(SEE NOTE4).

PACKAGING
 BLANK: PVC TRAY.
 T: TAPE & REEL.

CONTACT AREA PLATING:
 D: 15u" GOLD.
 E: 30u" GOLD.

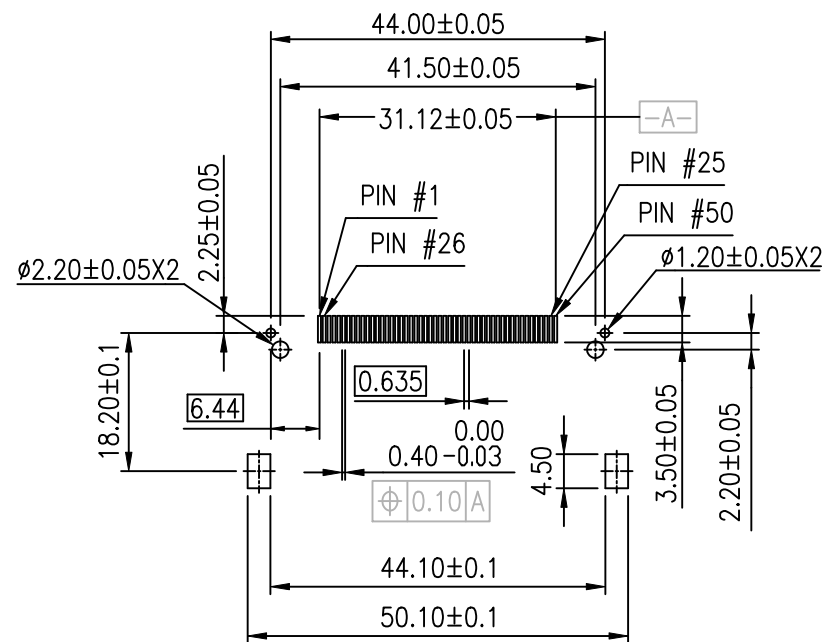

P.C.B Layout

Tous droits strictement reserves. Reproduction ou communication a des tiers interdite sous quelque forme que ce soit sans autorisation ecrite du proprietaire. Propriete de c FCI. Droits de reproduction FCI.



All rights strictly reserved. Reproduction or issue to third parties in any form whatever is not permitted without written authority from the proprietor. Property of FCI. Copyright FCI.

| | | | | | | | | | | | |
|-------------|----------------|----|------|---------------------------------------|--------------|-----------|-------|---------------|------------|---------------------------|--|
| mat'l. code | | | | tolerances unless otherwise specified | | | | CUSTOMER COPY | | FCI www.fciconnect.com | |
| ltr | ecn no | dr | date | linear | .X ± 0.30 | | | | projection | title | |
| H | | | | | .XX ± 0.20 | | | | | CF CARD HEADER TYPE 1 | |
| | | | | | .XXX ± 0.10 | | | | | | |
| | | | | angles | 0° ±2° | | | | MM | product family | |
| | | | | dr | JASON HSU | 01/09/03' | scale | | | code | |
| | | | | engr | JASON HSU | 01/09/03' | A4 | | | TWN | |
| | | | | chr | STERLING LIN | 01/09/03' | | | sheet | | |
| | | | | appd | JAMES HSU | 01/09/03' | | | 3 of | | |
| sheet index | revision sheet | | | | | | | | | | |