

SEE DETAIL "A"

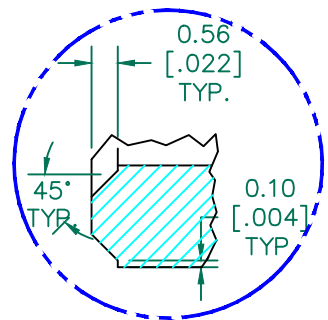

CHAMFER
DETAIL A
(N.T.S.)

**UNCONTROLLED
DOCUMENT**

NOTES: UNLESS OTHERWISE SPECIFIED
1. COSMETIC SPECIFICATION REFER TO WI-QA-038.

IMPEDANCE (Z)			
Frequency	25 MHz	100 MHz	300 MHz
Nominal (REF)	89 Ω	184 Ω	303 Ω
Minimum	- Ω	142 Ω	- Ω

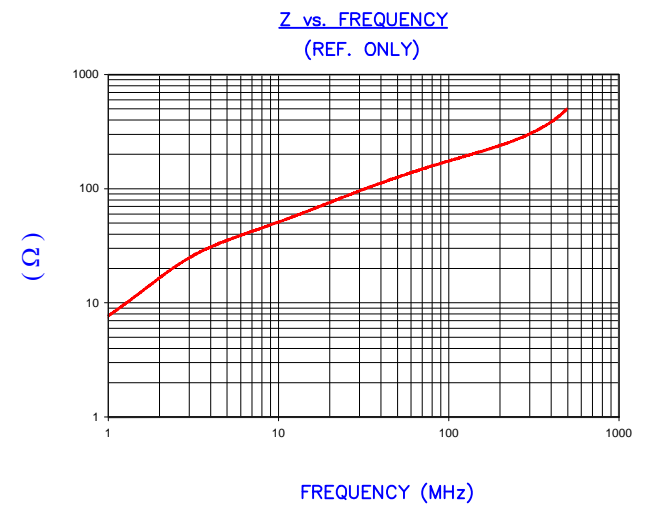

AGILENT E4991A Impedance/Material Analyzer
HP 16092A Test Fixture, REF#3333

FERRITE CORE DIMENSIONS (SPEC): mm [in]

A	14.27 [.562]	±	0.25 [.010]
B	6.35 [.250]	±	0.15 [.006]
C	13.46 [.530]	±	0.25 [.010]

WEIGHT/1000 8.42 kgs 18.56 lbs.

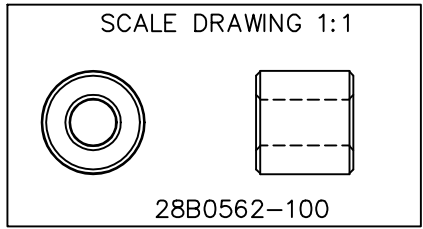

DIMENSIONS ARE IN mm [INCHES].				This print is the property of Laird Tech. and is loaned in confidence subject to return upon request and with the understanding that no copies shall be made without the written consent of Laird Tech. All rights to design or invention are reserved.					
REV	DESCRIPTION	DATE	INT						
M	UPDATE THE LOGO	05/13/15	QIU	PROJECT/PART NUMBER: 28B0562-100		REV	M	PART TYPE: CNZ CORE	DRAWN BY: DJB
L	UPDATED Z SPEC	03/25/11	Jcai			SCALE: 2 : 1	MATERIAL: Ferrite		
K	CHG CHAMFER DESIGN BACK TO ANGLED	04/10/09	JRK	DATE: 04/03/92	TOOL # B0562				
J	UPDATE COMPANY LOGO, PART WGT CHANGE CHAMFER DESIGN	03/23/09	JRK						
H	UPDATE MIN Z SPEC @100 MHZ AND UPDATE COMPANY LOGO	07/30/07	TMB						
G	UPDATE MIN Z SPEC @100 MHZ	10/04/06	JRK						
F	UPDATE MIN Z SPEC, ADD TEST REF	12/03/04	JRK						
REV	DESCRIPTION	DATE	INT						